



1515 WOODFIELD RD - SUITE 1200

SCHAUMBURG CORPORATE CENTER

# 24,700 RSF

1475, 1501, 1515 E Woodfield Rd  
Schaumburg, IL 60173

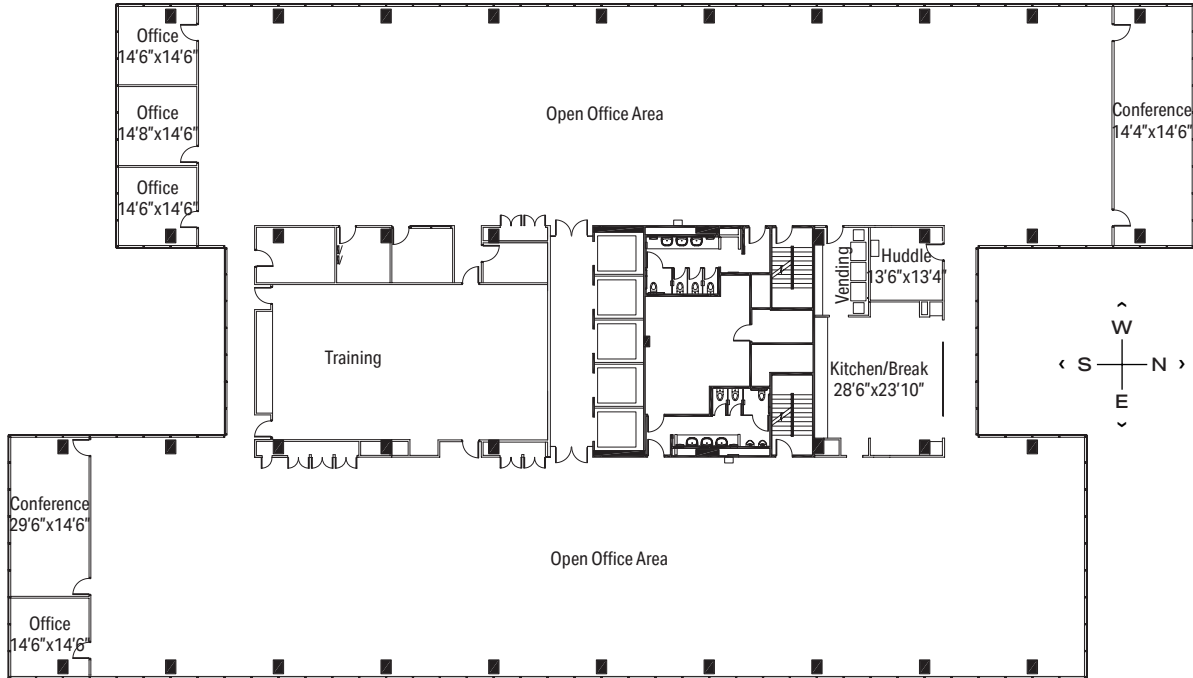

[VIRTUAL TOUR →](#)

### LEASING

**Bill Saviski**  
Managing Director  
bsaviski@glenstar.com  
773 837 5290

—

**Christian Domin**  
Managing Director  
cdomin@glenstar.com  
312 925 6304

SchaumburgCorporateCenter.com

### PROPERTY HIGHLIGHTS

- Class A amenity package including 17,000 SF atrium
- Complimentary Midtown Athletic Club membership for tenants
- Parking garage with connected pedway and heated executive parking
- Glenstar Connect Program

### SUITE FEATURES

- Full floor suite
- Part of a contiguous block up to 98,800 RSF
- Abundant window line with views to the exterior
- Large, light-filled open office areas for workstations

