



1501 WOODFIELD RD - SUITE 425E/450E

# 12,076 RSF

**SCHAUMBURG CORPORATE CENTER**

1475, 1501, 1515 E Woodfield Rd  
Schaumburg, IL 60173

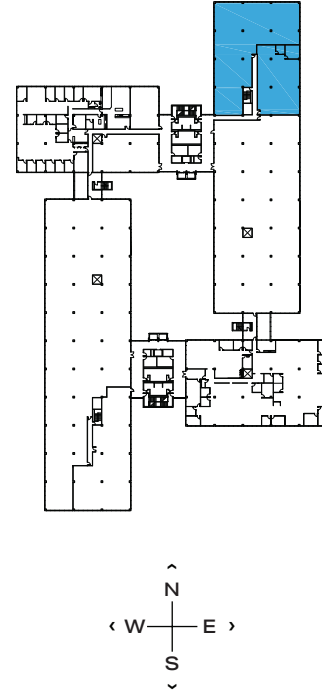
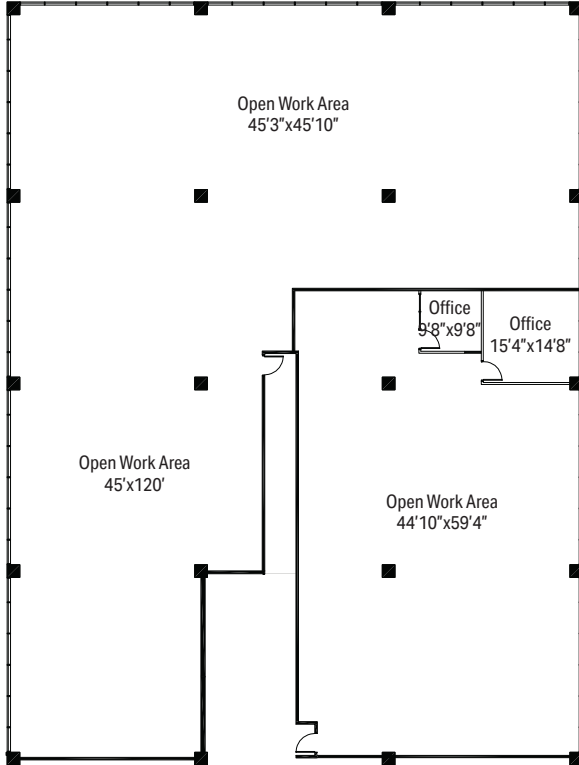

### LEASING

**Bill Saviski**  
**Managing Director**  
 bsaviski@glenstar.com  
 773 837 5290

—

**Christian Domin**  
**Managing Director**  
 cdomin@glenstar.com  
 312 925 6304

SchaumburgCorporateCenter.com

### PROPERTY HIGHLIGHTS

- Class A amenity package including 17,000 SF atrium
- Complimentary Midtown Athletic Club membership for tenants
- Parking garage with connected pedway and heated executive parking
- Glenstar Connect Program

### SUITE FEATURES

- Raw space
- New ceiling grid and new parabolic light fixtures in place
- Exterior exposure on three sides

